

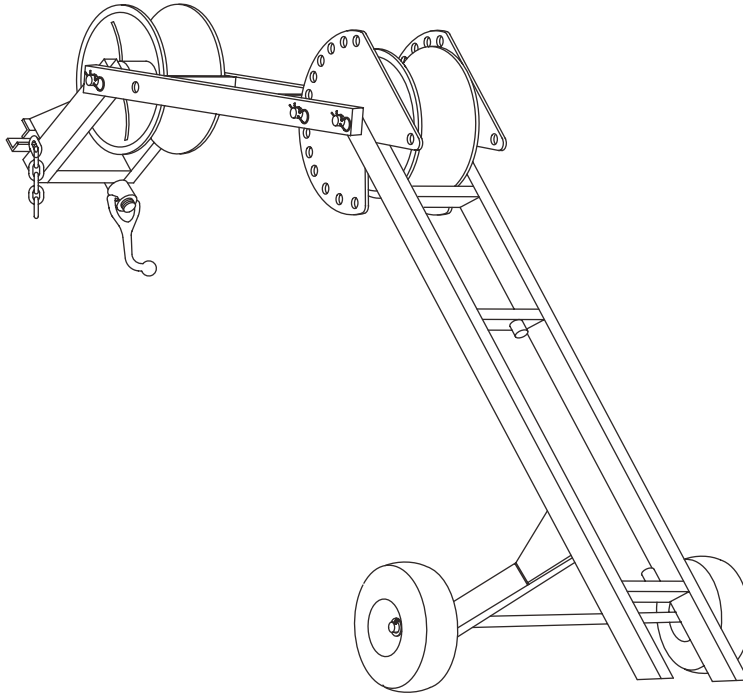

# ***Current Tools***

**FOR THE PROFESSIONAL ELECTRICIAN**

**Current Tools™ Model 8080  
Mobile Cable Puller Cart  
*for use with Current Tools™ Model 88 Cable Puller***



## **Operating, Maintenance, Safety and Parts Manual**

06/09 - REV. 1



**Read and understand this material before operating or servicing this Mobile Cable Puller Cart. Failure to understand how to safely operate and service this unit may result in serious injury or death.**



**The Current Tools Model 88 Cable Puller manual should also be read and understood before attaching to and operating with the Model 8080 Mobile Cable Puller Cart.**

These manuals are free of charge. All personnel who operate or service this Mobile Cable Puller Cart and Model 88 Cable Puller should have a copy of these manuals and read and understand their contents. To request a copy, call or write to the address below.

CURRENT TOOLS • P. O. BOX 17026 GREENVILLE, SC 29606  
800.230.5421 or 864.244.1201 • FAX 864.244.5860  
[www.currenttools.com](http://www.currenttools.com)

## **TABLE OF CONTENTS – 8080 Mobile Cable Puller Cart**

<b><i>Safety Information</i></b> .....	<b>2, 3</b>
<b><i>Mounting Instructions for Model 88 Cable Puller</i></b> .....	<b>4</b>
<b><i>Specifications</i></b> .....	<b>5</b>
<b><i>Mounting Chain Installation Procedure</i></b> .....	<b>5</b>
<b><i>Set-Up Procedure</i></b> .....	<b>6</b>
<b><i>Common Set-Ups</i></b> .....	<b>7, 8, 9</b>
<b><i>Exploded View of Model 8080 Cable Puller Cart</i></b> .....	<b>10</b>
<b><i>Parts List</i></b> .....	<b>11</b>

### — RETAIN SAFETY INFORMATION —

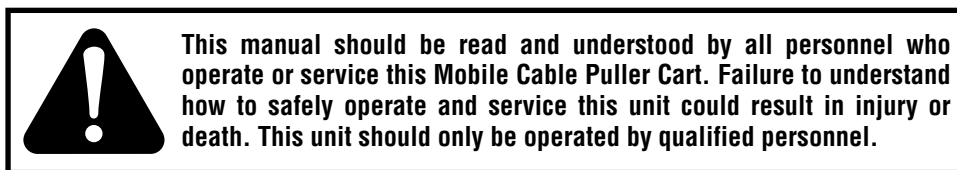

## **IMPORTANT SAFETY INFORMATION**

- DO NOT operate in wet or damp locations. DO NOT expose to rain.
- Only use the mobile cable puller cart for its intended purpose.
- NEVER alter or weld on any part of the mobile cable puller cart.
- NEVER operate in an explosive atmosphere.
- ALWAYS inspect the structural integrity of any flooring, conduit, etc. that will support the forces generated during the pull. These should be able to withstand the maximum forces of the Model 88 Cable Puller (which will be attached to the Model 8080 Mobile Cable Puller Cart) PLUS a safety factor of at least 3:1. *For example: Model 88 Cable Puller is 8,000 lbs. max. pull x 3 = 24,000 lbs. including safety factor.*
- Check to insure cable puller is properly attached to the cart before operating.
- Check to insure all pins are the correct part number for the assembly and are fully inserted through holes and have spring clips properly attached before beginning pull.
- Keep all body parts, hair, loose clothing, etc. away from rotating parts and pinch points.

*continued on next page . . .*

## IMPORTANT SAFETY INFORMATION continued . . .

- Pin extension arm in transport position with pin number 8080-8 before moving Model 8080 Mobile Cable Puller Cart. Keep unit under control when transporting. Roll only on a firm, level surface.

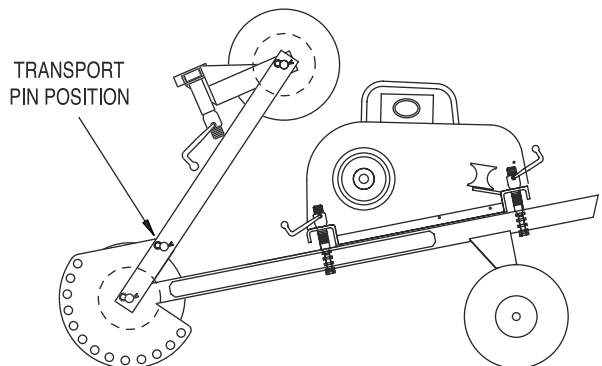

Do not allow the Mobile Cable Puller Cart and Cable Puller to hang from slip-in or screw-on couplings. Damage to couplings and other components may occur.



Do not use screw-on couplings when pulling in PVC conduit. Couplings may detach and cause serious injury or death. Only use the slip-in couplings when pulling in PVC conduit.

### **WARNING**

Never use the flexible adapter by itself. The 8080 Mobile Cable Puller Cart must always be used as a complete system. Never use any component separately. Failure to follow this warning may result in serious injury or death.

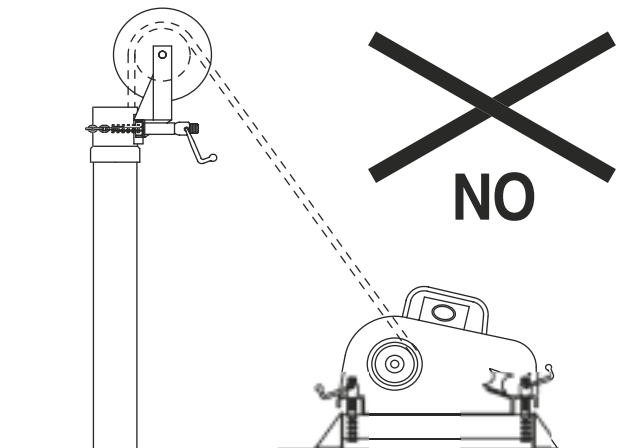

# MOUNTING INSTRUCTIONS – Model 88 Cable Puller

## **WARNING**

Before operating the Current Tools Model 88 Cable Puller, refer to the Operating, Maintenance, Safety, and Parts Manual.

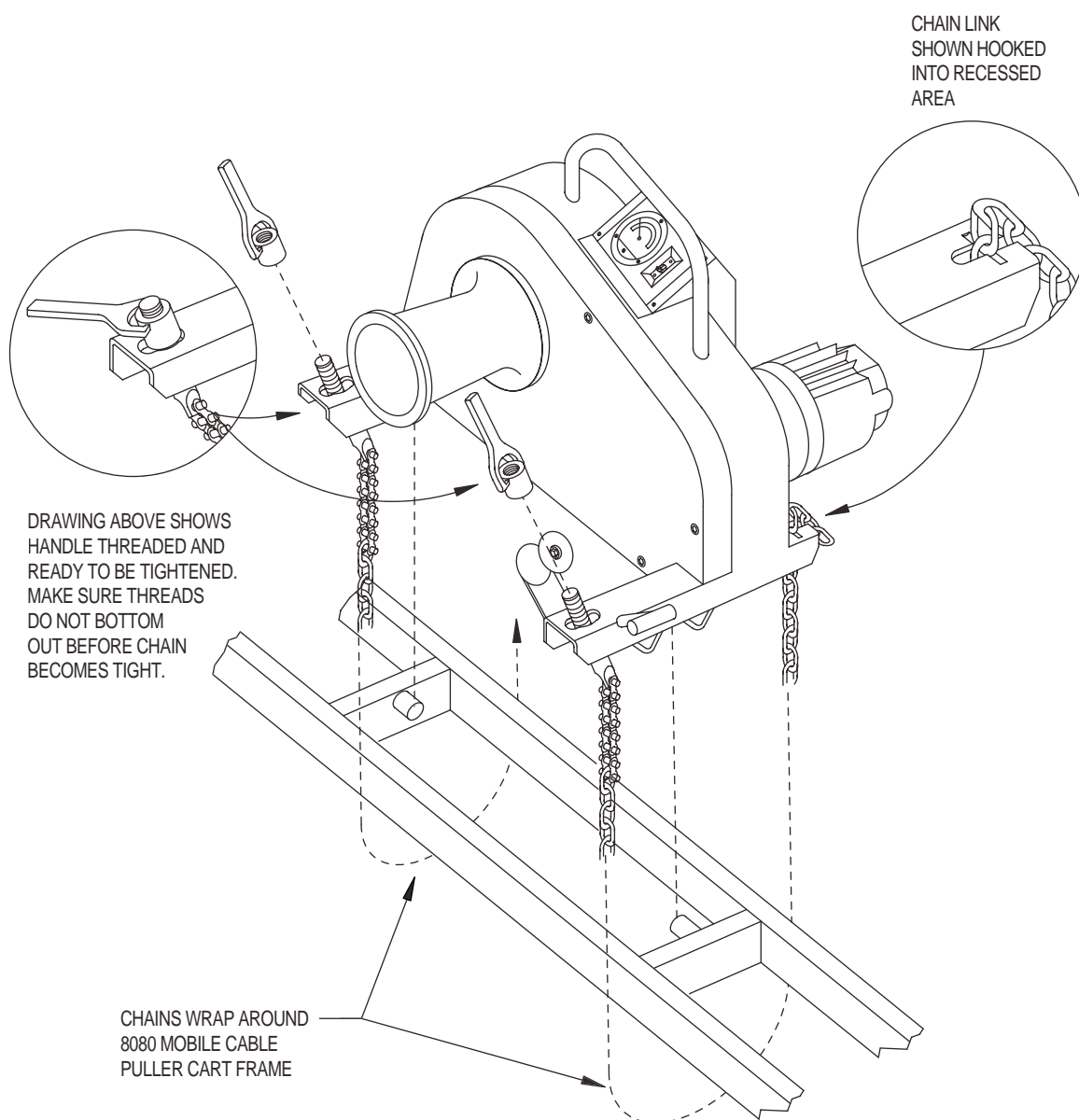

FIGURE 1

## SPECIFICATIONS — 8080 Mobile Cable Puller Cart

- width** – 28"  
**height** – 34 5/8" (resting on floor – pinned in transport position)  
**weight** – 115 lbs. (including screw-on couplings)

## MOUNTING CHAIN INSTALLATION PROCEDURE

The Model 88 Cable Puller is designed to be mounted using the two mounting chains provided. The handles on the chains should provide sufficient leverage to tighten the chains securely. No other tools are needed. Be sure to check the mounting chains for kinks and twists before you tighten them.

1. Loosen the mounting chain handle so that only 3 or 4 threads remain engaged.

2. Wrap the chain around the 8080 Mobile Cart frame. ( See figure 1, on page 4. )

3. Pull the loose end of the mounting chain tight and hook the closest chain link into the recessed area. ( See figure 1, on page 4. )

4. Tighten the chain handle.  
Repeat this process for the second mounting chain.

### **WARNING**

Never tighten chain as shown in Figure A. This causes side loading of the chain and can result in failure of the chain or screw causing components to come loose and possibly cause serious injury or death. Figure B shows the proper alignment of screw and chain for tightening.

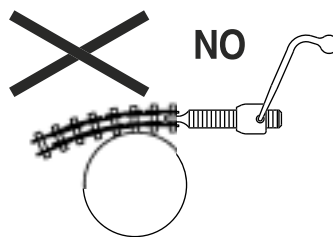

FIGURE A

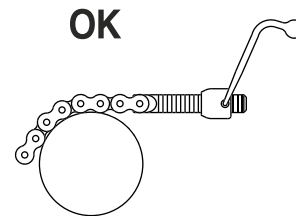

FIGURE B

**NOTE: Be sure threads Do NOT bottom out before chains become tight.**

### — IMPORTANT —

1. THE ONLY APPROVED METHOD TO SECURE THE MODEL 88 CABLE PULLER IS WITH THE 2 MOUNTING CHAINS PROVIDED WITH THE MODEL 88 CABLE PULLER. DO NOT ATTEMPT TO USE ANY OTHER OBJECT TO SECURE THE PULLER.
2. INSPECT MOUNTING CHAINS FOR WEAR BEFORE EACH INSTALLATION.
3. DO NOT SIDE-LOAD THREADED ROD WHEN TIGHTENING CHAINS.



## SET-UP PROCEDURE – 8080 Mobile Cable Puller Cart

1. Choose the correct size screw-on or slip-in coupling for the conduit you will be connecting to for the pull.
2. FOR SCREW-ON COUPLING, thread the coupling onto the conduit at least 4 full turns. ( Inspect the threads on the conduit to make sure they are in good condition. )

FOR SLIP-IN COUPLING, slip the correct size coupling into the conduit.

3. Move the Mobile Cable Puller Cart close enough to the conduit to allow the flexible adapter to reach the coupling.
4. Remove the positioning hole pin ( 8080-8 ) which allows the extension arm of the cart to pivot. This allows you to pivot the flexible adapter into position against the coupling. Connect flexible adapter to coupling with the mounting chain.
5. Adjust the position of the main frame section of the cart and re-insert the pin ( 8080-8 ) into a positioning hole.
6. At this point, make sure the back runners of the cart are resting on a firm, level surface.



**Do not allow the Mobile Cable Puller Cart and Cable Puller to hang from slip-in or screw-on couplings. Damage to couplings and other components may occur.**



## COMMON SET-UPS — 8080 Mobile Cable Puller Cart

### — UP PULL USING SCREW-ON COUPLING —

#### **! WARNING !**

Screw-on couplings can be used for both up and down pulls.  
Slip-in couplings can only be used for up pulls.

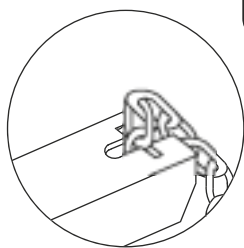

VIEW ABOVE SHOWS  
CHAIN HOOKED ON  
OPPOSITE SIDE OF  
FLEXIBLE ADAPTER

POSITION FLEXIBLE  
ADAPTER TO COUPLING  
AND SECURE WITH  
MOUNTING CHAIN.  
FLEXIBLE ADAPTER  
PIVOTS SO THAT IT  
IS PLUMB WITH  
COUPLING.

THREAD FEMALE  
END OF SCREW-ON  
COUPLING ONTO  
CONDUIT. SCREW-ON  
COUPLINGS MUST  
THREAD ONTO  
CONDUIT A MINIMUM  
OF FOUR FULL TURNS.  
CONDUIT THREADS  
MUST BE IN GOOD  
CONDITION.

EXTENSION ARM CAN PIVOT  
AND MUST BE PINNED  
INTO ONE OF THE  
POSITIONING HOLES.

CONDUIT

POSITIONING HOLES

TRANSPORT PIN HOLE

POSITION CABLE PULLER  
ONTO MOBILE CART AS  
SHOWN AND SECURE  
WITH MOUNTING CHAINS  
(SEE CABLE PULLER  
MOUNTING INSTRUCTIONS  
ON PAGE 4)

#### **! WARNING !**

Do not use screw-on couplings when pulling in  
PVC conduit. Couplings may detach and cause  
serious injury or death. Only use the slip-in  
couplings when pulling in PVC conduit.

#### **! WARNING !**

The Mobile Cable Puller Cart must rest on back runners when  
making a cable pull. Runners must rest on a firm, level surface.



## COMMON SET-UPS — 8080 Mobile Cable Puller Cart

### — DOWN PULL USING SCREW-ON COUPLING —

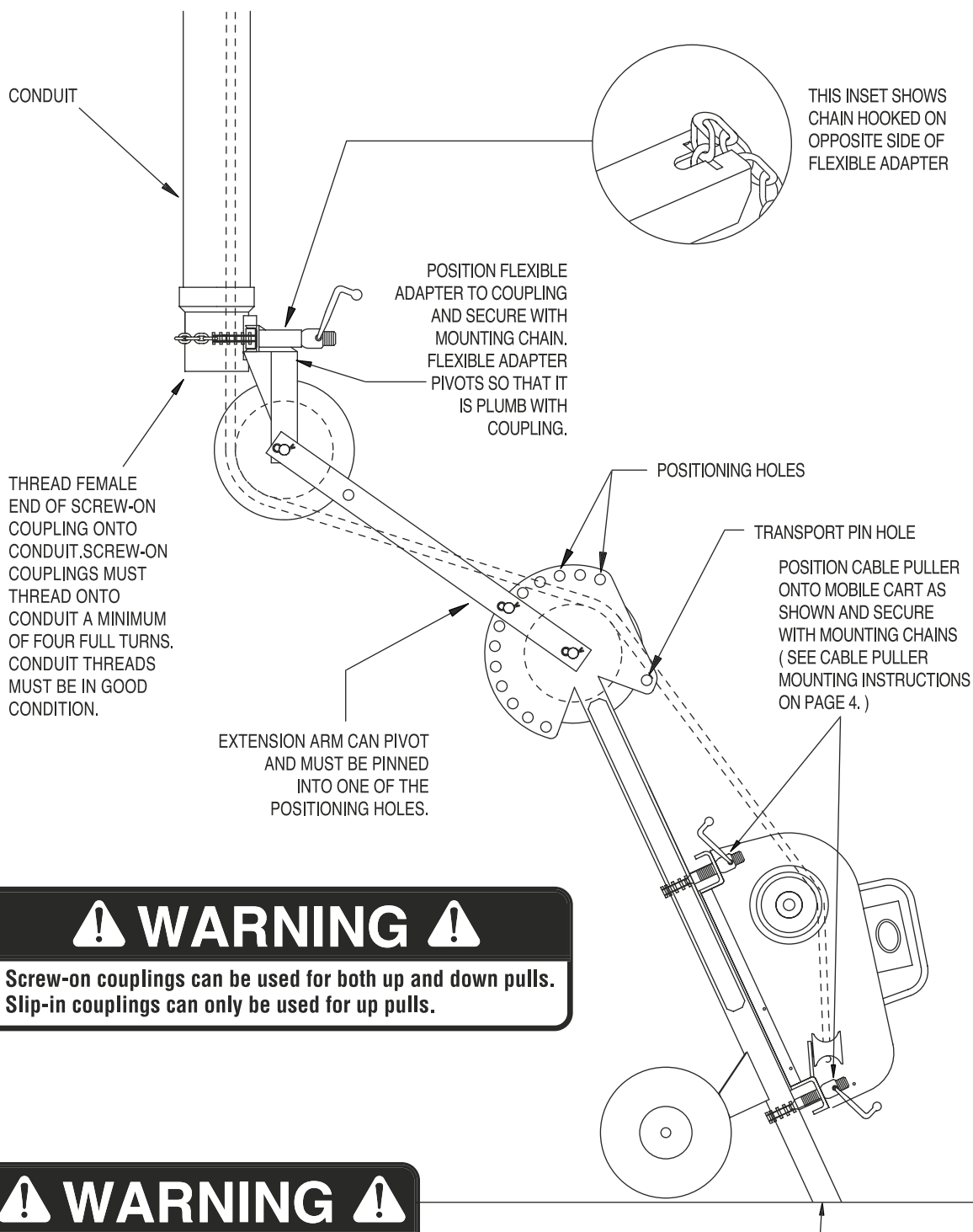

#### **⚠ WARNING ⚠**

Screw-on couplings can be used for both up and down pulls. Slip-in couplings can only be used for up pulls.

#### **⚠ WARNING ⚠**

Do not use screw-on couplings when pulling in PVC conduit. Couplings may detach and cause serious injury or death. Only use the slip-in couplings when pulling in PVC conduit.

#### **⚠ WARNING ⚠**

The Mobile Cable Puller Cart must rest on back runners when making a cable pull. Runners must rest on a firm, level surface.

# COMMON SET-UPS — 8080 Mobile Cable Puller Cart

## — UP PULL USING SLIP-IN COUPLING —

### ⚠ WARNING ⚠

Slip-in couplings can only be used for up pulls. Screw-on couplings can be used for both up and down pulls.

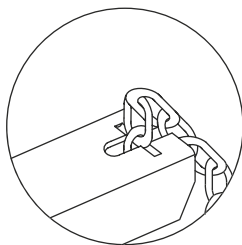

VIEW ABOVE SHOWS CHAIN HOOKED ON OPPOSITE SIDE OF FLEXIBLE ADAPTER.

SLIP-IN COUPLING

LONG END OF COUPLING SLIPS INTO CONDUIT

POSITION FLEXIBLE ADAPTER TO COUPLING AND SECURE WITH MOUNTING CHAIN. FLEXIBLE ADAPTER PIVOTS SO THAT IT IS PLUMB WITH COUPLING.

POSITIONING HOLES

TRANSPORT PIN HOLE

POSITION CABLE PULLER ONTO MOBILE CART AS SHOWN AND SECURE WITH MOUNTING CHAINS (SEE CABLE PULLER MOUNTING INSTRUCTIONS)

EXTENSION ARM CAN PIVOT AND MUST BE PINNED INTO ONE OF THE POSITIONING HOLES.

CONDUIT

### ⚠ WARNING ⚠

Do not use screw-on couplings when pulling in PVC conduit. Couplings may detach and cause serious injury or death. Only use the slip-in couplings when pulling in PVC conduit.

### ⚠ WARNING ⚠

The Mobile Cable Puller Cart must rest on back runners when making a cable pull. Runners must rest on a firm, level surface.

# EXPLODED VIEW

## 8080 MOBILE CABLE PULLER CART

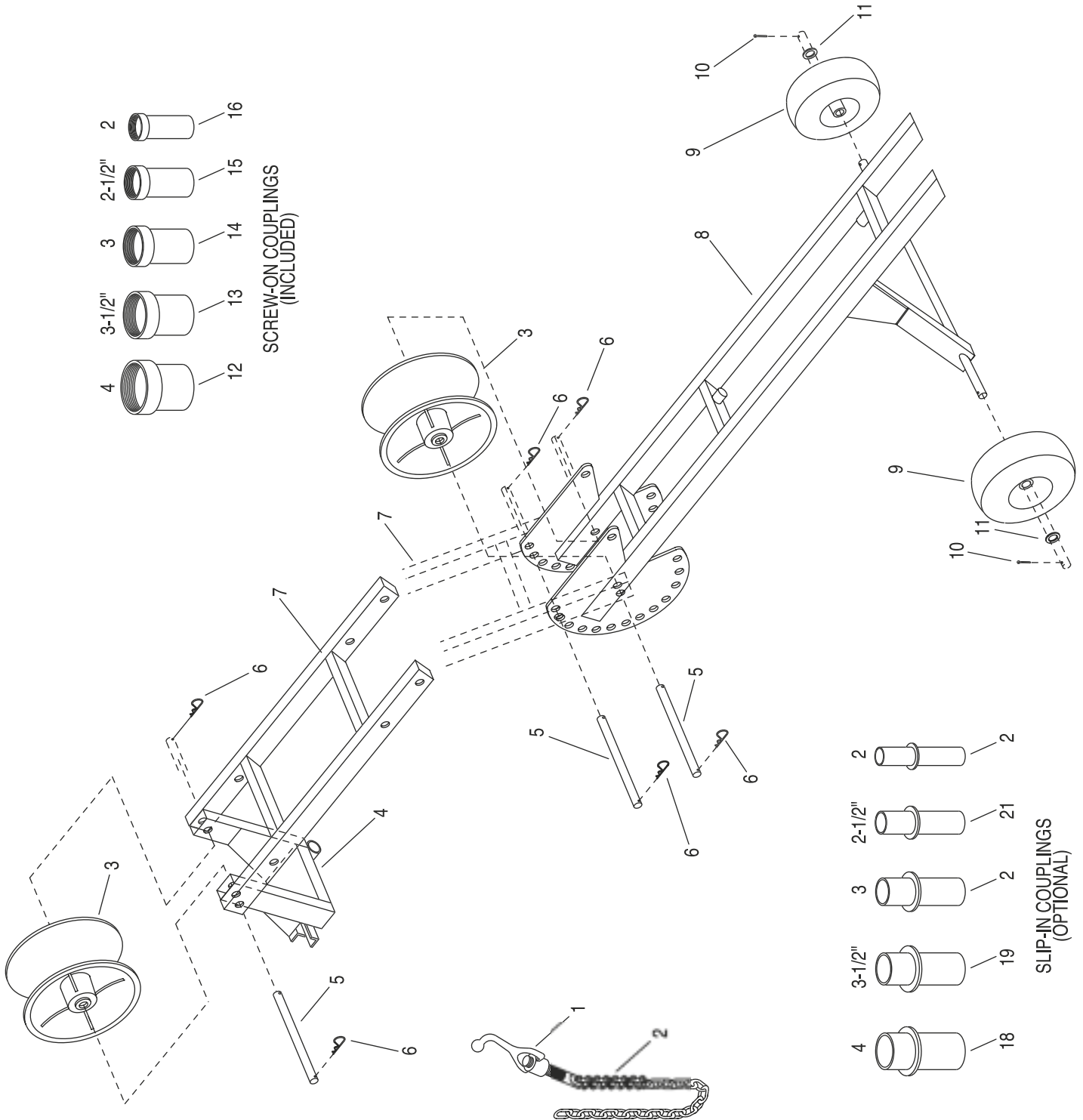



## PARTS LIST — 8080 Mobile Cable Puller Cart

<u>ITEM#</u>	<u>PARTS #</u>	<u>QTY</u>	<u>DESCRIPTION</u>
1 .....	88-42 .....	1 .....	NUT WITH HANDLE
2 .....	88-21 .....	1 .....	CHAIN ASSEMBLY
3 .....	412-4 .....	2 .....	12" SHEAVE WHEEL
4 .....	8042-3 .....	1 .....	FLEXIBLE ADAPTER
5 .....	8080-8 .....	3 .....	PIN, SHEAVE – 3/4" Dia. X 10 7/8"
6 .....	206 .....	6 .....	SPRING CLIP
7 .....	8080-1 .....	1 .....	EXTENSION ARM
8 .....	8080-7 .....	1 .....	MAIN FRAME
9 .....	8080-6 .....	2 .....	WHEEL
10 .....	1/8 x 1 1/4 cotter pin .....	2 .....	COTTER PIN
11 .....	3/4 SAE flat washer .....	2 .....	FLAT WASHER
12 .....	8050 .....	1 .....	THREAD ON COUPLING – 4"
13 .....	8049 .....	1 .....	THREAD ON COUPLING – 3 1/2"
14 .....	8048 .....	1 .....	THREAD ON COUPLING – 3"
15 .....	8047 .....	1 .....	THREAD ON COUPLING – 2 1/2"
16 .....	8046 .....	1 .....	THREAD ON COUPLING – 2"
17 .....	8040 .....	1 - <i>optional</i> .....	SLIP-IN COUPLING – 4"
18 .....	8039 .....	1 - <i>optional</i> .....	SLIP-IN COUPLING – 3 1/2"
19 .....	8038 .....	1 - <i>optional</i> .....	SLIP-IN COUPLING – 3"
20 .....	8037 .....	1 - <i>optional</i> .....	SLIP-IN COUPLING – 2 1/2"
21 .....	8036 .....	1 - <i>optional</i> .....	SLIP-IN COUPLING – 2"